

Email: [orders@adpaustralia.com.au](mailto:orders@adpaustralia.com.au) | Phone: (02) 4271 2444

<b>Store:</b>	<b>Order Date:</b>
<b>Store Contact Name:</b>	<b>Purchase Order Number:</b>
<b>Store Phone Number:</b>	<b>Quote Number: (If applicable)</b>

Notes: \_\_\_\_\_

## Configuration

### Wall Hung



### Floor Mount

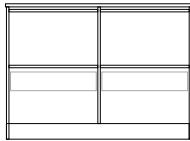

## Size

600 Centre	1200 Centre	1500 Double
750 Centre	1200 Left Offset	1800 Centre
750 Left Offset	1200 Right Offset	1800 Left Offset
750 Right Offset	1200 Double	1800 Right Offset
900 Centre	1500 Centre	1800 Double
900 Left Offset	1500 Left Offset	
900 Right Offset	1500 Right Offset	

OR

### Custom Width (charges apply)

Please specify overall benchtop size, cabinet will be made to suit

Width: \_\_\_\_\_ mm (Min 540mm / Max 2.2m or 2.4m Cabinet Only - No benchtop)

Depth & height cannot be changed.

## Cabinet Finish

### Woodgrain/Silk Only (Excludes Polyurethane)

Colour: \_\_\_\_\_

(Check ADP website for non-standard colours available, surcharges apply).

## Benchtop Finish

Cherry Pie      Durasein      Caesarstone Mineral

Colour: \_\_\_\_\_

OR

Cabinet only (No benchtop)

## Basin

Name: \_\_\_\_\_

Code: \_\_\_\_\_

Colour: \_\_\_\_\_

## Tap Hole Location

### 0 tap hole - please specify:

Drilling own      Wall Taps      In basin

### 3 tap holes

### 1 tap hole - please specify location:

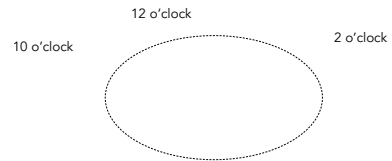

## Plug & Waste Colour

Chrome (supplied with vanity)	Brushed Nickel (additional cost)
Gloss White (additional cost)	Brushed Brass (additional cost)
Matte White (additional cost)	Brushed Copper (additional cost)
Matte Black (additional cost)	

## Upgrade Options (surcharges apply)

### Upgrade Benchtop Thickness

40mm      60mm      90mm

### Add splashback to vanity (Min 90mm / Max 250mm)

Height: \_\_\_\_\_ mm

### Add In-drawer Power Point -      Left Drawer      Right Drawer

(Wall Hung: will go in bottom drawer / Floor Mount: will go in top drawer)

## Fillers & Infills (surcharges apply)

### Against Wall

Use when a drawer is up against a wall or when the wall is out of plumb.

#### Left Side

#### Right Side

Filler (no changes will be made to the cabinet, installer to trim filler strip down to size on site if needed)

OR

Infill (reduce the cabinet by 10mm)

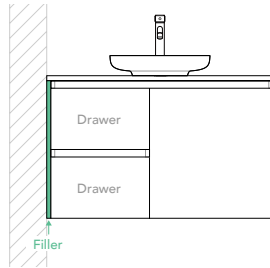

OR

### Between Wall\*

Use when the vanity is going in between two walls.

#### Infill x 2

(reduce the cabinet by 20mm)

*\*Not recommended for use with ceramic tops.*

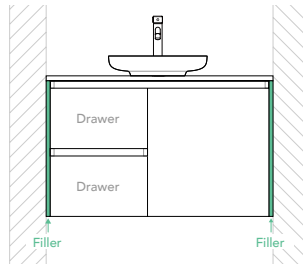

OR

### Against Wall with Architrave

Use when the drawer will not clear an architrave or obstruction (e.g. towel rail).

#### Wide Infill

60-100mm Infill (please specify):

\_\_\_\_\_ mm

(Cabinet width adjusted to suit)

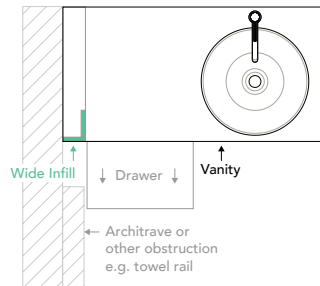

### Disclaimer:

I understand that this is a made to order product. The manufacturing process of this product will commence within 24 hours of receipt, therefore we are unable to accept alterations or cancellation after 24 hours. *\*This order form is for store use only\**

Customer Signature \_\_\_\_\_ Date \_\_\_\_\_