

# Soul.

# Floor Bath Spout Installation



Products in this manual must by regulation be installed by licensed and registered trade people.



## Water supply requirements

Not recommended for gravity fed water systems or water tanks.

Working Pressure: 350 - 500kpa (including cold and hot water pressure)  
 Maximum Pressure: 73psi / 500kpa  
 Temperature Rating: 5°C - 65°C (must not exceed 70°C)

Installation should comply with Australian standard AS/NZS 3500 or relevant local authority requirements.

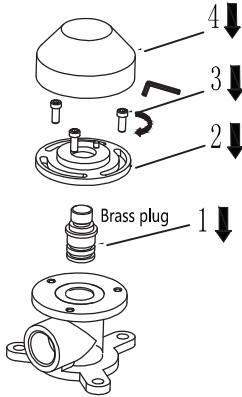

1. Insert Brass Plug (1) into Under Floor Water Inlet Body.
2. Fasten Installation Bracket (2) to Body.
3. Use Hex Key & Screws provided (3). Tighten.
4. Insert Protective Cap (4).

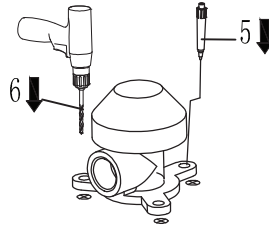

5. Mark fixing points onto the fixing surface.
6. Drill appropriate holes for fixings.

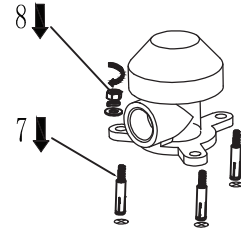

7. Insert sleeves or appropriate dynabolt for surface situation.
8. Fasten fixings.

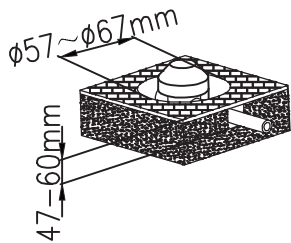

Note: Water inlet supply pipe 47-60mm from finished floor level. Hole diameter on finished floor 57-67mm.

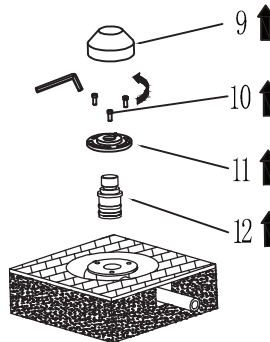

9. Remove Protective Cap (4).
10. Unscrew Fixing Screws (3) using Hex Key.
11. Remove Installation Bracket (2).
12. Remove Brass Plug (1).



Note: Discard Brass Plug (1)

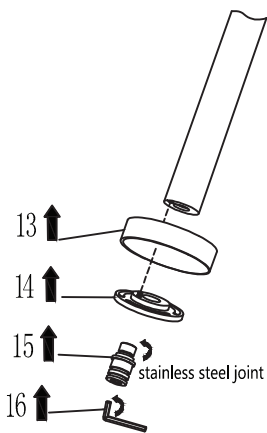

13. Insert Dress Ring (13) onto Spout.
14. Position Installation Bracket (2).
15. Fasten stainless steel Spout Connector (15) to Installation Bracket and Spout.
16. Use Hex Key (16) provided to fasten.

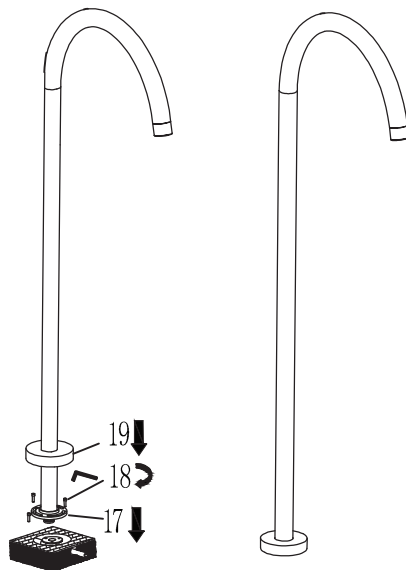

17. Fasten Installation Bracket with hex screws supplied onto water inlet body.
18. Tighten.
19. Slide Dress Ring over Installation Bracket.

