

Knobs

Glacier All-Door Vanities

HANDLE POSITIONING GUIDE

All knobs (*excluding Vale*) are centred to the door and are set down 50mm from the top of the door face.

Refer to diagrams below for visual guide.

Slim

600-900

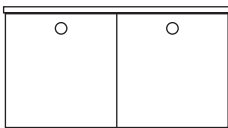

1050-1500

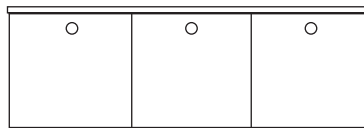

1800

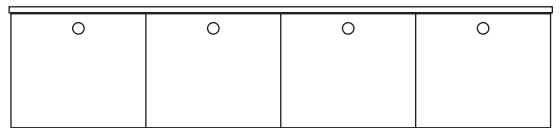

Twin

600-900

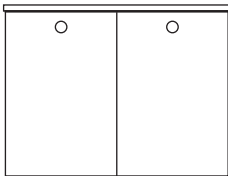

1050-1500

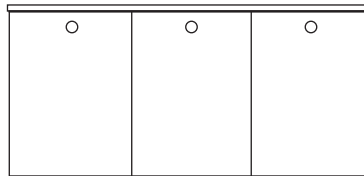

1800

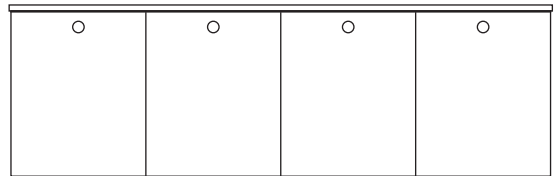

Trio

600-900

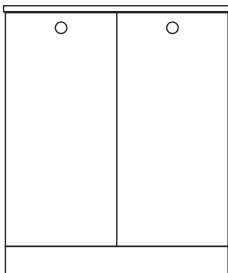

1050-1500

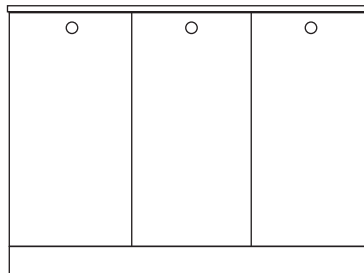

1800

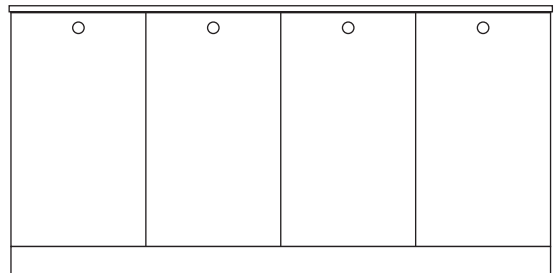

NOTE: When adding shaker classic door fronts the handle will be set down 50mm from the inside of the door profile.

Handles

Glacier All-Door Vanities



HANDLE POSITIONING GUIDE

All face mount handles are centred to the door and are set down 50mm from the top of the door face.

Refer to diagrams below for visual guide.

Slim

600-900

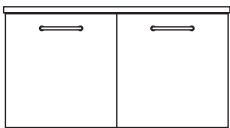

1050-1500

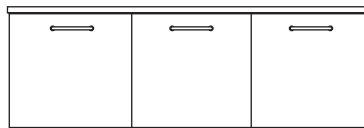

1800

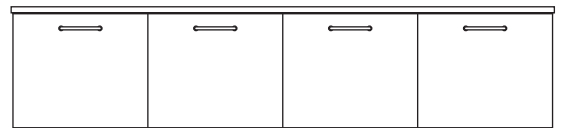

Twin

600-900

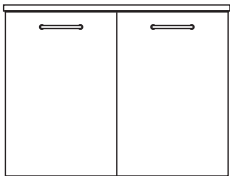

1050-1500

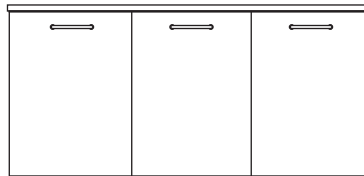

1800

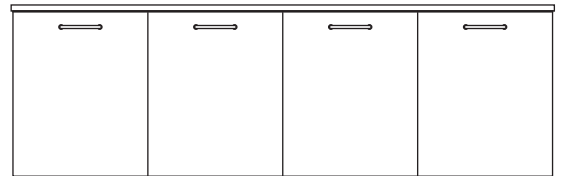

Trio

600-900

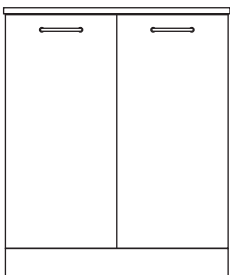

1050-1500

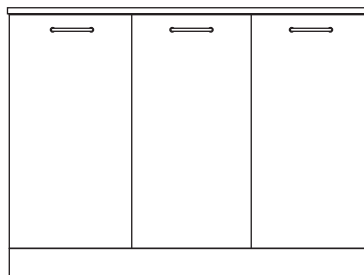

1800

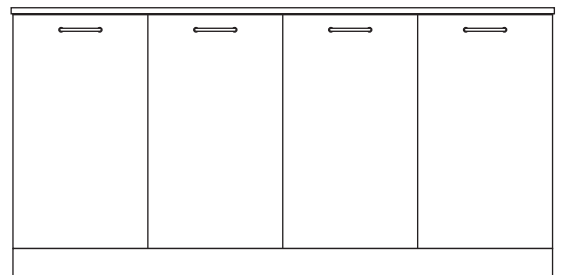

NOTE: When adding shaker classic door fronts the handle will be set down 50mm from the inside of the door profile.

HANDLE POSITIONING GUIDE

All lip pulls are centred to the door and will sit over the top of the door.

Refer to diagrams below for visual guide.

Slim

600-900

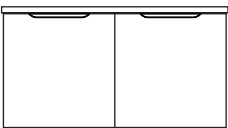

1050-1500

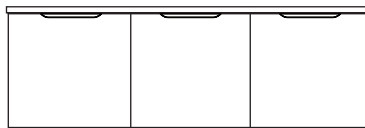

1800

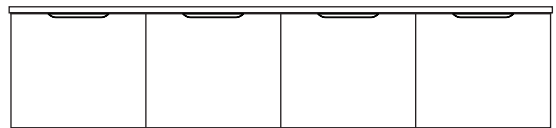

Twin

600-900

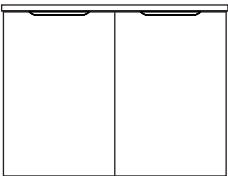

1050-1500

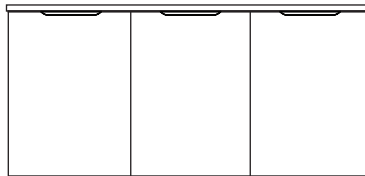

1800

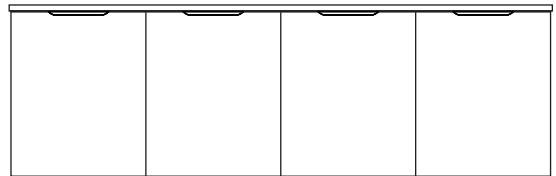

Trio

600-900

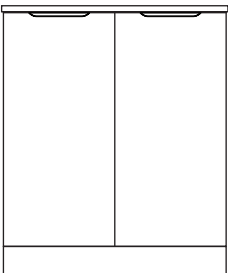

1050-1500

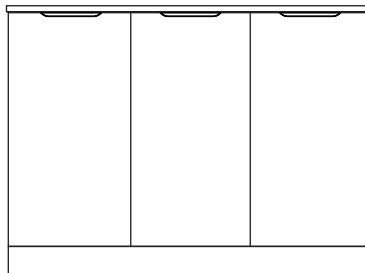

1800

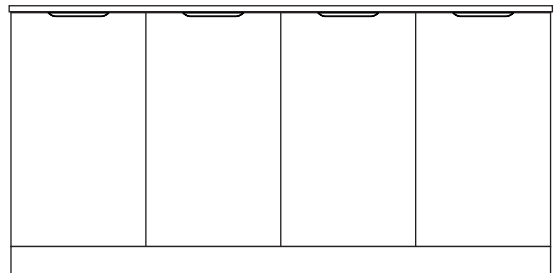

HANDLE POSITIONING GUIDE

Vale knobs are centred to the door and are set down 100mm from the top of the door face.

Refer to diagrams below for visual guide.

Slim

600-900

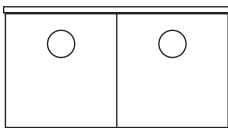

1050-1500

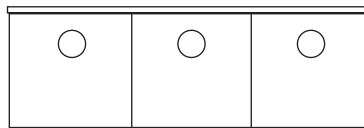

1800

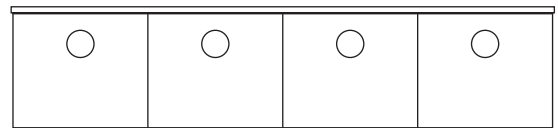

Twin

600-900

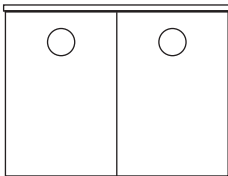

1050-1500

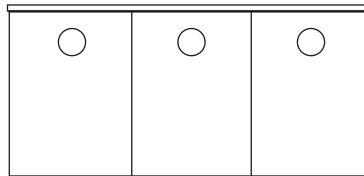

1800

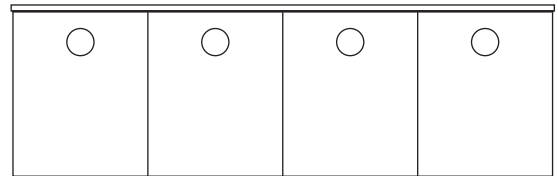

Trio

600-900

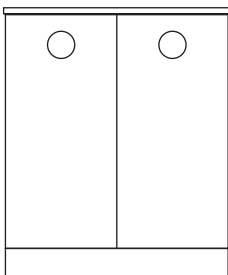

1050-1500

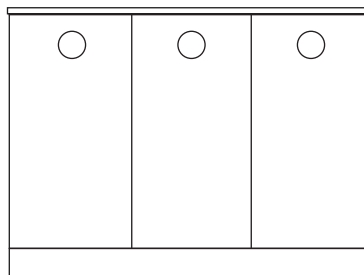

1800

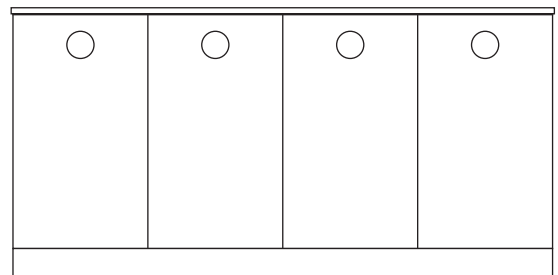

NOTE: When adding shaker classic door fronts the handle will be set down 100mm from the inside of the door profile.