

FLOATING SHELF INSTALLATION

Adp

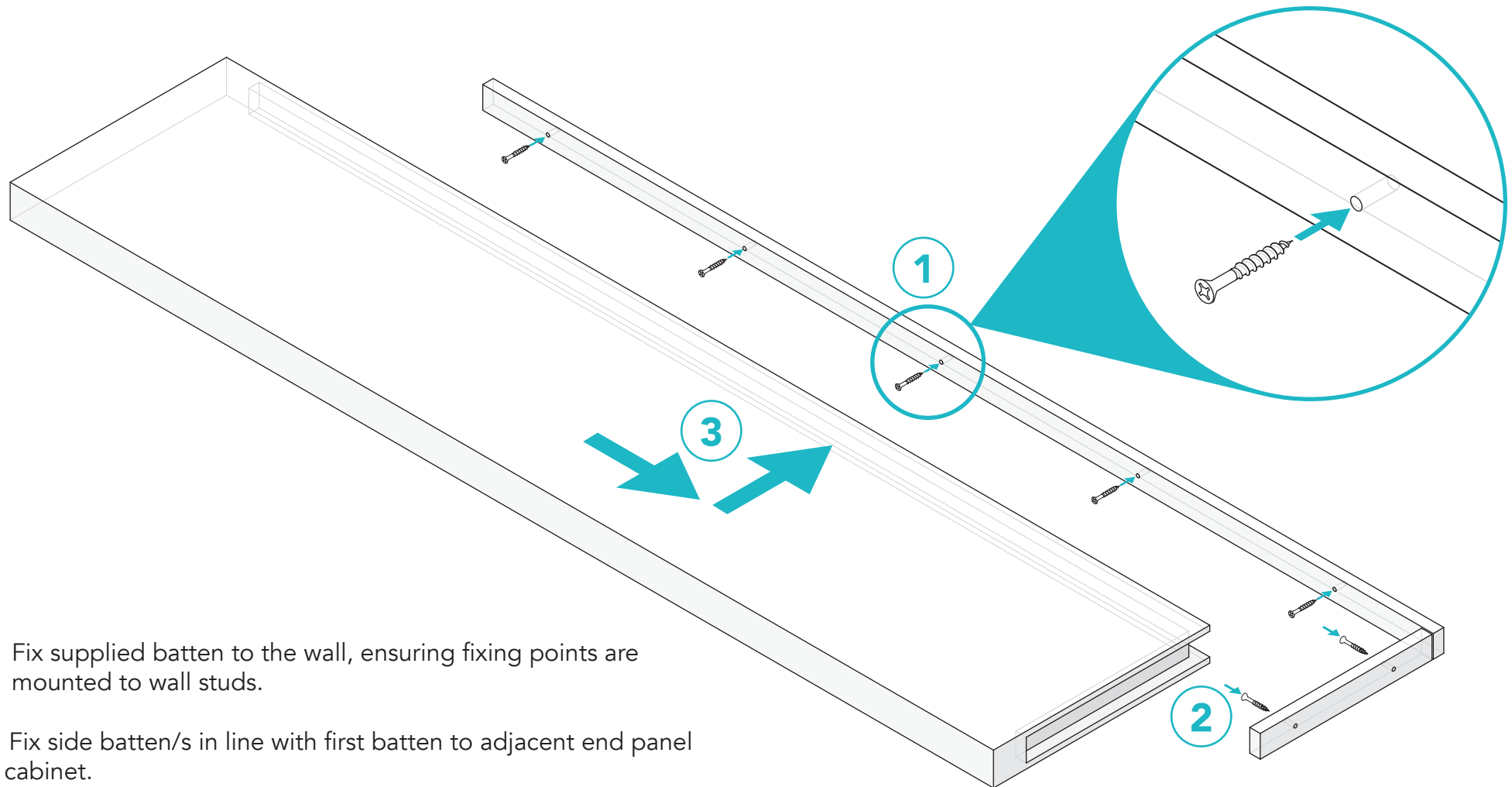

1. Fix supplied batten to the wall, ensuring fixing points are mounted to wall studs.
2. Fix side batten/s in line with first batten to adjacent end panel or cabinet.
3. Slide shelf onto battens.

Optionally screw through shelf into batten with a small fixing screw.
(Reccomened to do on the side not typically visible from eye level)