

Glacier Hamper Vanity



Email: orders@adpaustralia.com.au | Phone: (02) 4271 2444

Store: _____

Order Date: _____

Store Contact Name: _____

Purchase Order Number: _____

Store Phone Number: _____

Quote Number: *(If applicable)* _____

Notes: _____

1 Vanity Configuration

Trio Floor Mount

Please select for cabinet only
(If selected, skip steps 2 & 3)

750 Left Bowl

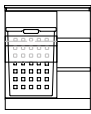

750 Right Bowl

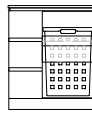

900 Left Bowl

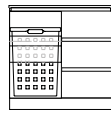

900 Right Bowl

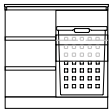

1050 Left Bowl

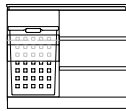

1050 Right Bowl

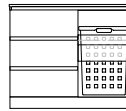

1200 Centre Bowl

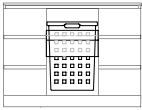

1500 Centre Bowl

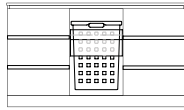

1500 Double Bowl

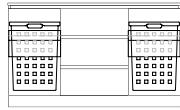

1800 Double Bowl

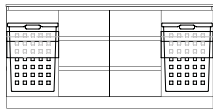

1800 Centre Bowl

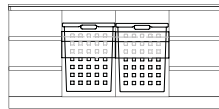

Vanity Interior

Glacier Lite
(Fresh White)

Glacier Pro
(Premium Graphite)

Vanity Exterior

Woodgrain

Silk

Polyurethane

Colour: _____

(Check ADP website for non-standard colours available, surcharges apply).

2 Benchtop & Basin

Benchtop

20mm Cherry Pie

12mm Durasein

20mm Caesarstone Mineral

Colour: _____

(For benchtop upgrade options - See across page)

Basin - Refer to ADP website for compatibility

(Only available for benchtop options)

Above-Counter

Semi-Inset

Product Code: _____ Colour: _____

Product Name: _____

*If not using ADP basin please provide current specs.
Note: Under-Counter basins are not suitable for this vanity.*

3 Taphole Location

0 tap hole - please specify:

Drilling own Wall Taps In basin

3 tap holes

1 tap hole - please specify location:

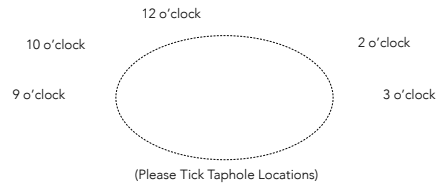

4 Handles & Extras

Handles

(Premium handles are included with Pro models at no extra charge, Lite models incur extra charge)

Bevel-Grip

Handle

Handle Name: _____

Handle Finish: _____ Handle Size: _____

5 Plug & Waste Colour

Chrome (supplied with vanity)

Brushed Nickel (additional cost)

Gloss White (additional cost)

Brushed Brass (additional cost)

Matte White (additional cost)

Brushed Copper (additional cost)

Matte Black (additional cost)

6 Upgrade Options (surcharges apply)

Upgrade to Statement benchtop

40mm

60mm

90mm

OR

Upgrade to 60mm Royale benchtop (Durasein Only)

16mm Filler Strip -

Left Side

Right Side

Both Sides

(Cabinet width not adjusted)

Single Infill 16mm

Double Infill 16mm

Wide Infill _____ mm Specify width between 60-100mm

(Cabinet width adjusted to suit)

Add In-Drawer Power Point -

Left Drawer

Right Drawer

Note: Only fits in middle and bottom drawer.

Disclaimer:

I understand that this is a made to order product. The manufacturing process of this product will commence within 24 hours of receipt, therefore we are unable to accept alterations or cancellation after 24 hours. **This order form is for store use only**

Customer Signature _____ Date _____

The Glacier Hamper Vanity is not customisable.