

### HANDLE POSITIONING GUIDE

All knobs (**excluding Vale**) will be centred to the door or drawer and will be set down 50mm from the top of the door or drawer face.

Refer to diagrams below for visual guide.

### Slim

750-900

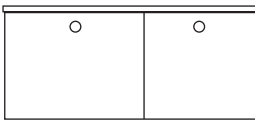

1050-1200

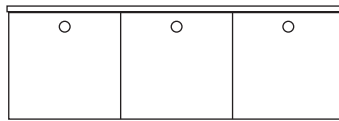

1500-1800

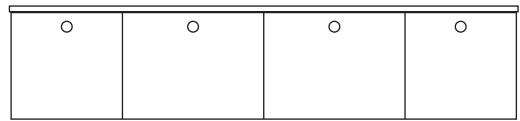

---

### Twin

750-900

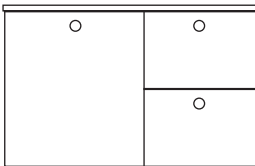

1050-1200

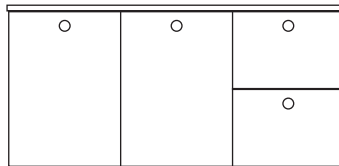

1500-1800

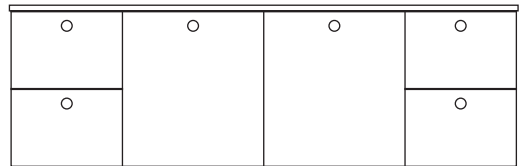

---

### Trio

750-900

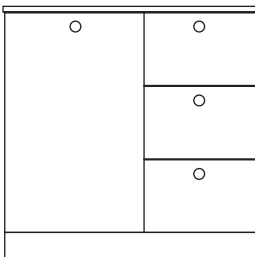

1050-1200

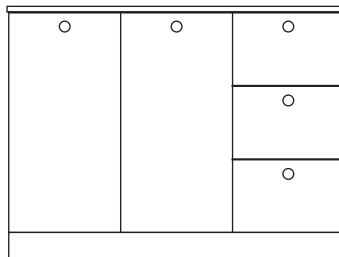

1500-1800

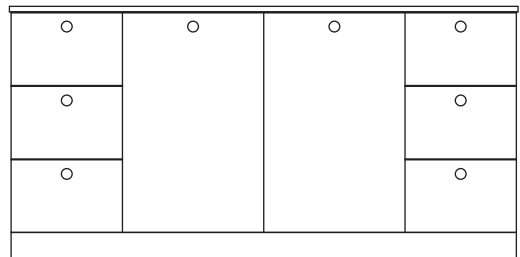

**NOTE:** When adding shaker classic door fronts the handle will be set down 50mm from the inside of the door profile.

# Handles

## Glacier Door & Drawer Vanities

### HANDLE POSITIONING GUIDE

All face mount handles will be centred to the door or drawer and will be set down 50mm from the top of the door or drawer face.

Refer to diagrams below for visual guide.

#### **Slim**

750-900

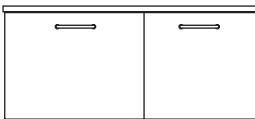

1050-1200

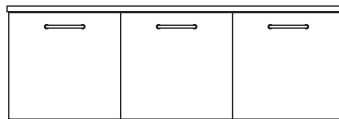

1500-1800

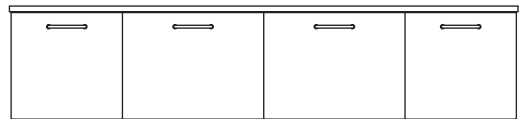

#### **Twin**

750-900

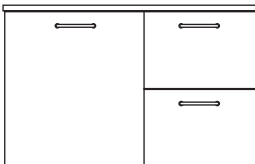

1050-1200

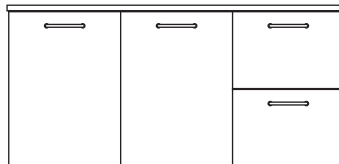

1500-1800

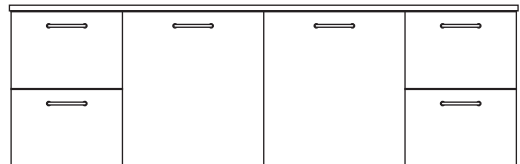

#### **Trio**

750-900

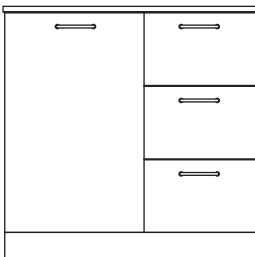

1050-1200

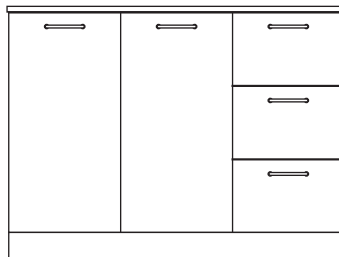

1500-1800

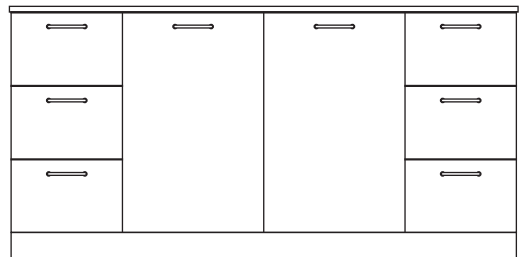

NOTE: When adding shaker classic door fronts the handle will be set down 50mm from the inside of the door profile.

# Lip Pulls

## Glacier Door & Drawer Vanities

### HANDLE POSITIONING GUIDE

All lip pulls will be centred to the door or drawer and will sit over the top of the door or drawer.

Refer to diagrams below for visual guide.

#### **Slim**

750-900

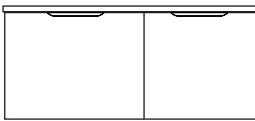

1050-1200

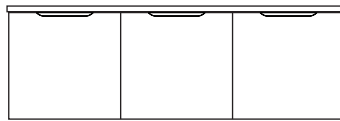

1500-1800

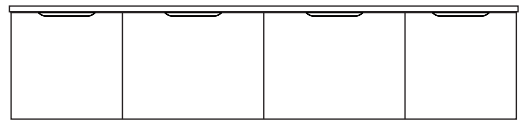

---

#### **Twin**

750-900

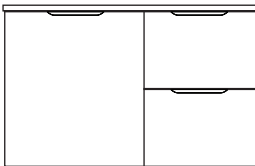

1050-1200

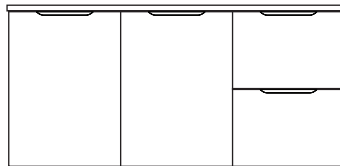

1500-1800

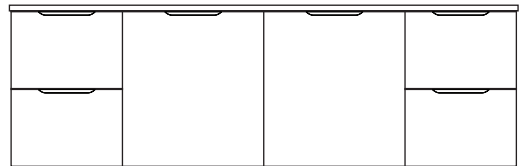

---

#### **Trio**

750-900

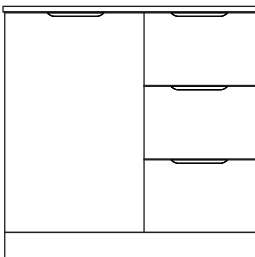

1050-1200

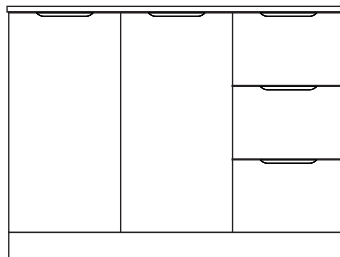

1500-1800

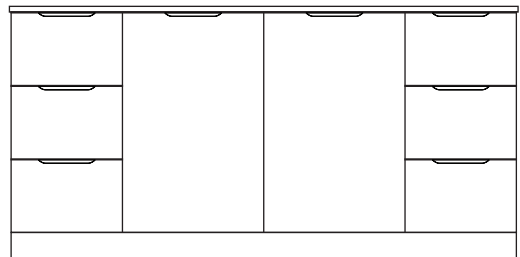

### HANDLE POSITIONING GUIDE

Vale knobs will be centred vertically and horizontally to every drawer and will be centred on doors horizontally, with the vertical position aligning with the upper most drawers.

*Refer to diagrams below for visual guide.*

### **Slim**

750-900

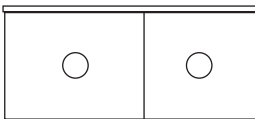

1050-1200

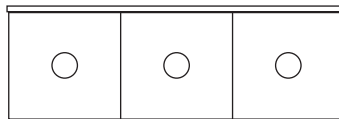

1500-1800

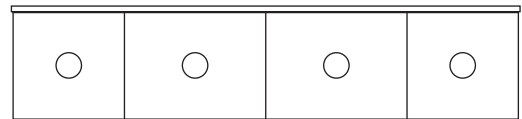

---

### **Twin**

750-900

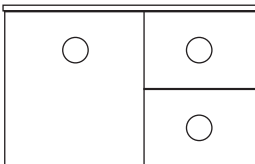

1050-1200

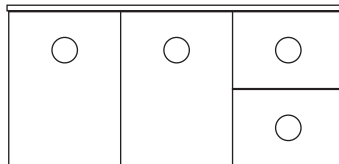

1500-1800

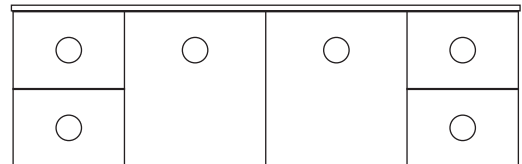

---

### **Trio**

750-900

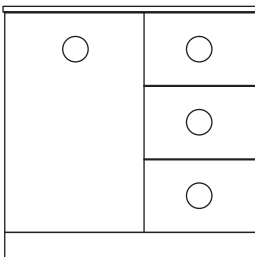

1050-1200

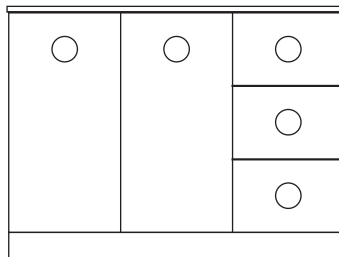

1500-1800

