

# Soul.

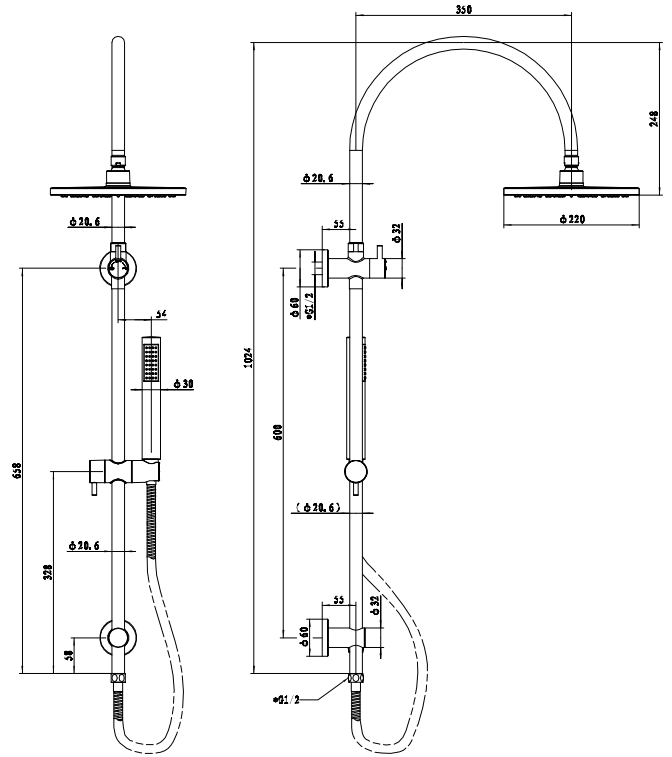

## Installation Guide: Soul Twin Shower Set

1. Drill 600mm below wall thread and screw in wall bracket.

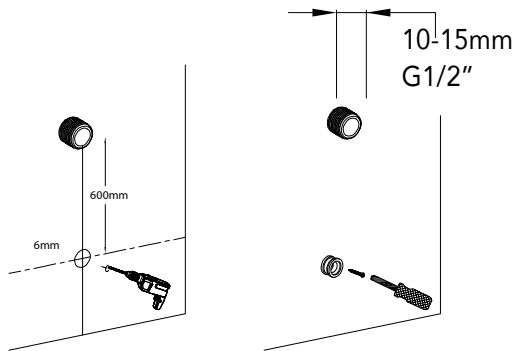

2. Apply thread tape and screw on diverter valve.

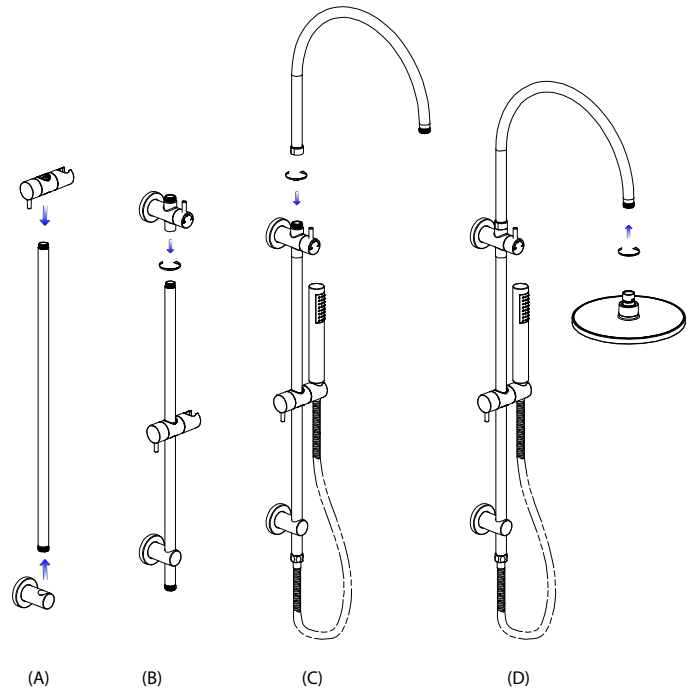
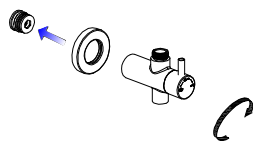

3.

- (A) Assemble slider onto rail and guide rail through bottom wall bracket.
- (B) Screw the top of rail into diverter valve.
- (C) Screw on the overhead arm and attach flexible hose and handshower.
- (D) Screw on the shower head.